



# Mini - Fit 4.2mm pitch Power Connector System Crimp Terminal and Housing

## 6656 Series

### FEATURES & BENEFITS:

- Dual row
- Designed for use with strain relief or overmold applications
- Fully isolated terminal to protect contacts from damage
- Four gas-tight points of contact

### SPECIFICATION:

#### Electrical:

- Voltage: 600V

Part No.	2	4-6	8-10	12-24	Wire range
T6656	9A	8A	7A	6A	18AWG
4200	12A	11A	10A	9A	

- Contact Resistance: 10m ohm max
- Dielectric Withstanding Voltage: 1500V AC
- Insulation Resistance: 1000M ohm min

#### Mechanical:

- Contact Insertion Force: 1.5kg max
- Contact Retention to Housing : 4.0kg min
- Wire Pull-out Force : 9.0kg min(#18).
- Mating Force: mate 0.7kg/per circuit
- Unmating Force: unmate 0.2kg/per circuit
- Durability: 30 Cycles

#### Physical:

- Housing: Nylon 66, UL94v-0 or UL 94V-2
- Contact: Phosphor Bronze or Brass
- Plating: Pre. Tin over Copper
- Temperature Range: -40°C to +105°C

### REFERENCE INFORMATION:

- UL File No.: E144574
- CSA File No.: LR80626-6
- Mates with YIYI 6659 Series or equivalent and YIYI 6669 Series Base
- Package: Terminal - Reel, Housing - Bag
- Designed in : mm

### ORDERING INFORMATION AND DIMENSIONS:

#### Terminal:

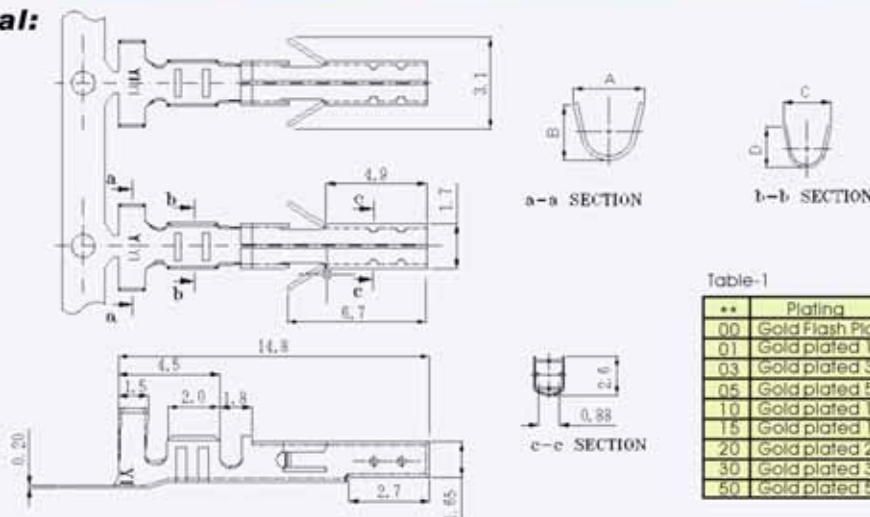

Table-1

**	Plating
00	Gold Flash Plated
01	Gold plated 1u*
03	Gold plated 3u*
05	Gold plated 5u*
10	Gold plated 10u*
15	Gold plated 15u*
20	Gold plated 20u*
30	Gold plated 30u*
50	Gold plated 50u*

Part No.	Material	Wire range	Finished	A	B	C	D
T6656-72F	Phosphor bronze	AWG# 18~24	Pre. Tin-plated	3.9	3.4	2.5	2.3
T6656-32F	Brass	AWG# 18~24	Pre. Tin-plated				
T6656-72F**	Phosphor bronze	AWG# 18~24	See table-1	4.4	4.5	2.6	2.9
T6656-32F**	Brass	AWG# 18~24	See table-1				
T6656-71F	Phosphor	AWG# 16	Pre. Tin-plated	4.4	4.5	2.6	2.9
T6656-31F	Brass	AWG# 16	Pre. Tin-plated				
T6656-71F**	Phosphor bronze	AWG# 16	See table-1	4.4	4.5	2.6	2.9
T6656-31F**	Brass	AWG# 16	See table-1				



**Mini - Fit**  
**4.2mm pitch**  
**Power Connector System**  
**Crimp Terminal and Housing**

**6656 Series**

**ORDERING INFORMATION AND DIMENSIONS:**

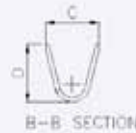
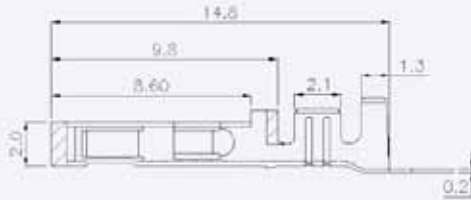
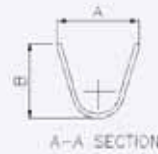
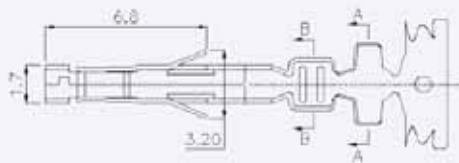

Part No.	Material	Range wire	Finish	A	B	C	D
4200B-01	Brass	AWG#18~22	Tin-plated	3.7	3.4	2.4	2.6
4200P-01	Phosphor bronze	AWG#18~22	Tin-plated				
4200B-01H	Brass	AWG#16	Tin-plated	3.7	3.4	3.0	3.4
4200P-01H	Phosphor bronze	AWG#16	Tin-plated				

**Housing:**

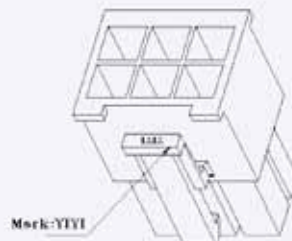

**Note:**

1. Part No: H6657-006E
2. Material: Nylon 66 94V-2 or 94V-0
3. Color: Black
4. Equivalent Molex: 45559-0002
5. Mating with T6656/4200 Series Terminal



**Mini - Fit**  
**4.2mm pitch**  
**Power Connector System**  
**Crimp Terminal and Housing**

**6656 Series**

**ORDERING INFORMATION AND DIMENSIONS:**

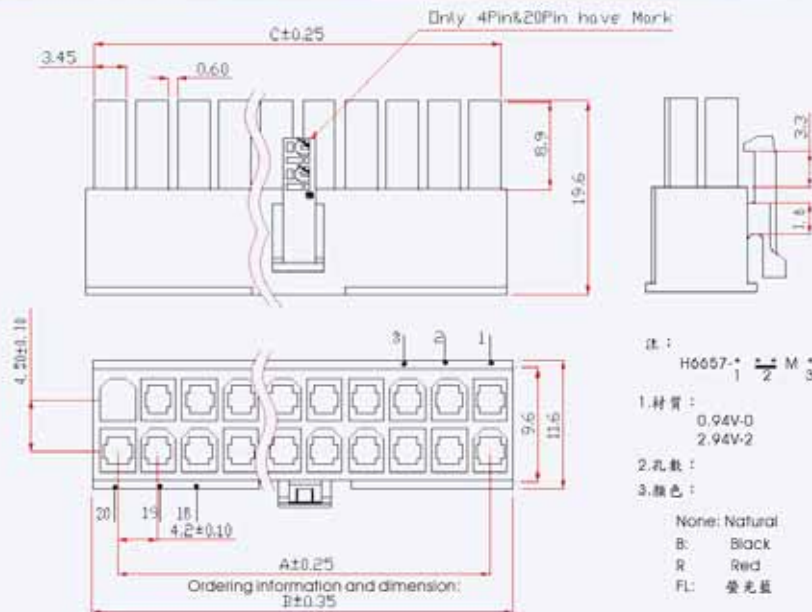

Circuits	Part No.		Dim. A	Dim. B	Dim. C	Material
	UL 94V-2	UL 94V-0				
2	H6657-202M*	H6657-002M*	---	5.5	---	Nylon 66
4	H6657-204M*	H6657-004M*	4.2	9.7	7.6	
6	H6657-206M*	H6657-006M*	8.4	13.9	11.8	
8	H6657-208M*	H6657-008M*	12.6	18.1	16.0	
10	H6657-210M*	H6657-010M*	16.8	22.3	20.0	
12	H6657-212M*	H6657-012M*	21.0	26.5	24.4	
14	H6657-214M*	H6657-014M*	25.2	30.7	28.6	
16	H6657-216M*	H6657-016M*	29.4	34.9	32.8	
18	H6657-218M*	H6657-018M*	33.6	39.1	37.0	
20	H6657-220M*	H6657-020M*	37.8	43.3	41.2	
22	H6657-222M*	H6657-022M*	42.0	47.5	45.4	
24	H6657-224M*	H6657-024M*	46.2	51.7	49.6	

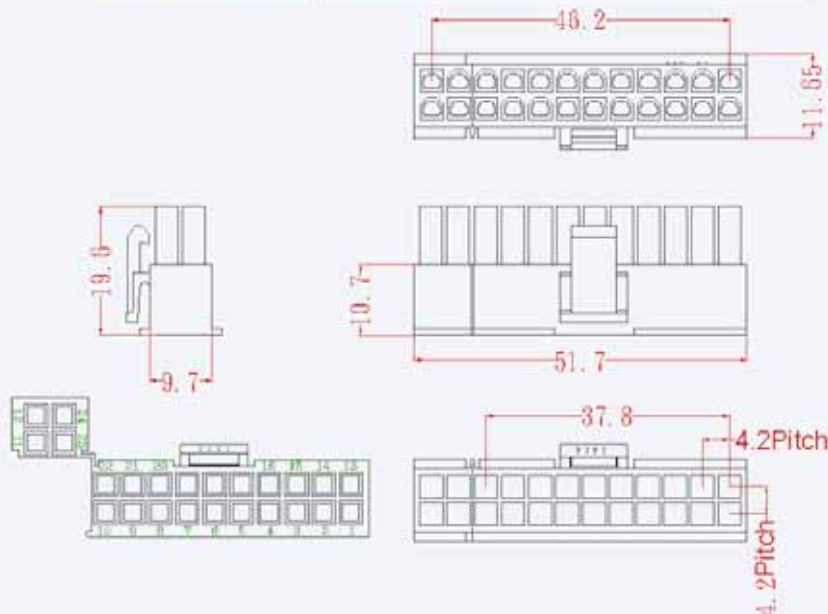

- Specifications:
1. Material: Pa66 UL 94V-2 or 94V-0, Natural or White
  2. Mate with: T6656/4200 series Terminal
  3. Mate with Base: B6669-243
  4. Part No.: H6657-224MJ(94V-2) H6657-024MJ(94V-0)



## 6656 Series

**Mini - Fit**  
**4.2mm pitch**  
**Power Connector System**  
**Crimp Terminal and Housing**

### ORDERING INFORMATION AND DIMENSIONS:

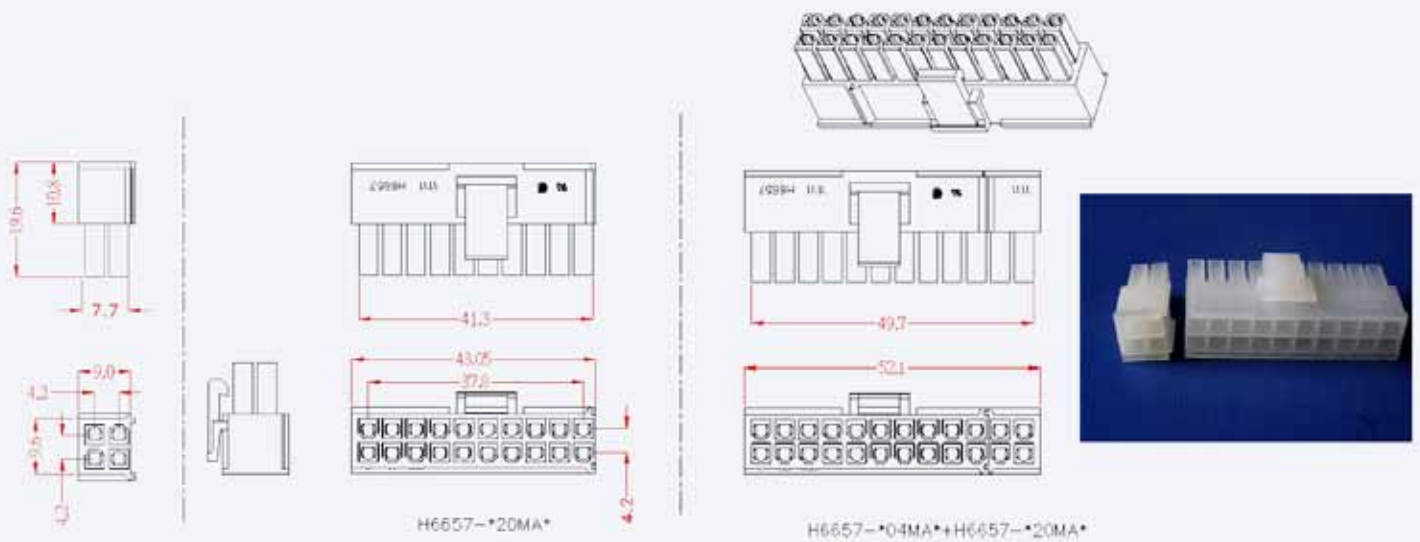

Part No.	Pins	Material	Color
H6657-204MA	4P	Nylon 66 94V-2	Natural
H6657-004MA		Nylon 66 94V-0	
H6657-220MA	20P	Nylon 66 94V-2	
H6657-020MA		Nylon 66 94V-0	
H6657-204MAB	4P	Nylon 66 94V-2	Black
H6657-004MAB		Nylon 66 94V-0	
H6657-220MAB	20P	Nylon 66 94V-2	
H6657-020MAB		Nylon 66 94V-0	

H6657-  $\frac{*}{1}$   $\frac{*}{2}$   $\frac{M}{3}$   $\frac{A}{4}$   $\frac{*}{5}$

- ① Material, 0:Nylon 94-0; 2:Nylon 94-2;
- ② Circuit, 04,20;
- ③ Type: Mate
- ④ Assemble,
- ⑤ Color, None: Natural;  
B:Black; R:Red....



**Mini - Fit**  
**4.2mm pitch**  
**Power Connector System**  
**Crimp Terminal and Housing**

**6656 Series**

**ORDERING INFORMATION AND DIMENSIONS:**

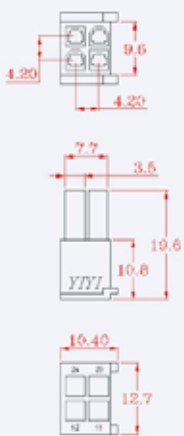

H6657-204MN

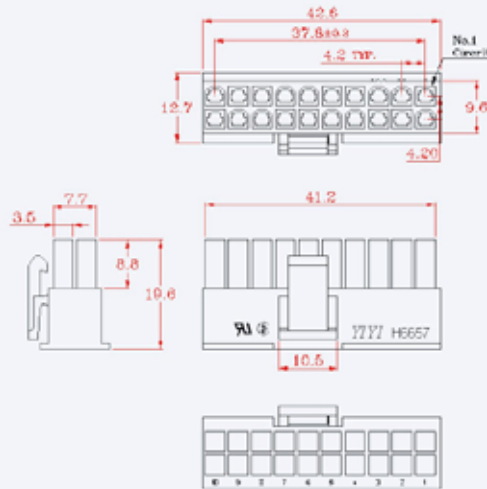

H6657-220MN



H6657-204MN + H6657-220MN

Ordering Information:

Part No.	Color	Material
H6657-204MN	Natural	Nylon 66 94V-2
H6657-204MNB	Black	
H6657-220MN	Natural	Nylon 66 94V-0
H6657-220MNB	Black	
H6657-004MN	Natural	Nylon 66 94V-0
H6657-004MNB	Black	
H6657-020MN	Natural	
H6657-020MNB	Black	



6657 Series

**ORDERING INFORMATION AND DIMENSIONS:**

**Housing:**

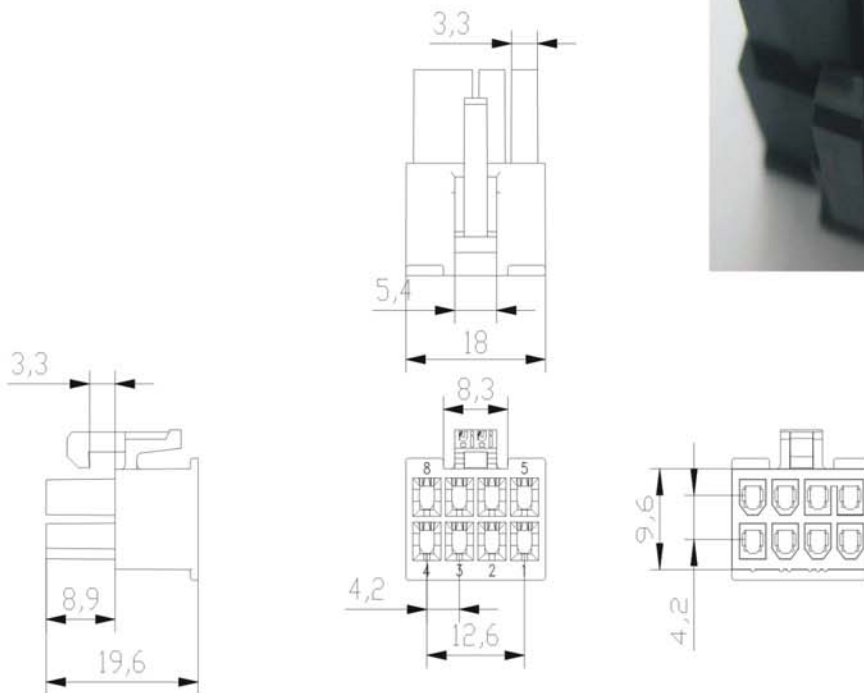

P/N	Material
H6657-208E	Nylon 66 94V-2 Black
H6657-008E	Nylon 66 94V-0 Black

**Mating with T6656 Series ,4200P Series Terminal.  
Mates Base:M8-I42002K12 or Equipment.**

## 6657 Series

### ORDERING INFORMATION AND DIMENSIONS:



#### Housing:

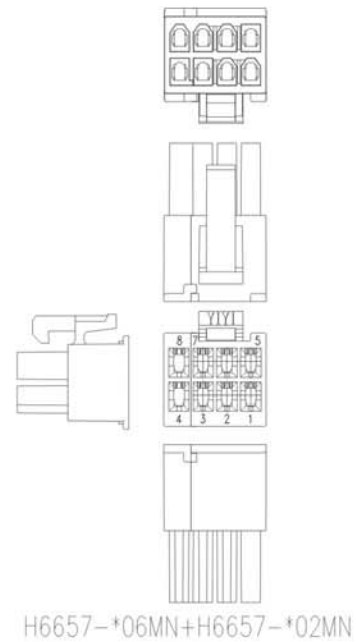
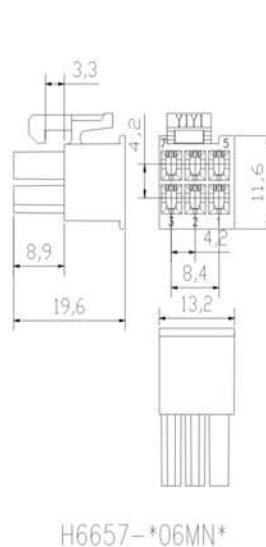
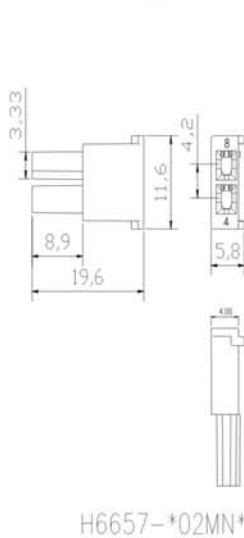

P/N	Material
H6657-206MN+H6657-202MN	Nylon 66 94V-2 Natural
H6657-006MN+H6657-002MN	Nylon 66 94V-0 White
H6657-206MNB+H6657-202MNB	Nylon 66 94V-2 Black
H6657-006MNB+H6657-002MNB	Nylon 66 94V-0 Black
H6657-206MNRE+H6657-202MNRE	Nylon 66 94V-2 Red
H6657-006MNRE+H6657-002MNRE	Nylon 66 94V-0 Red

**Mating with T6656 Series ,4200P Series Terminal.  
Mates Base:M8-I42002K12 or Equipment.**

6657 Series

**ORDERING INFORMATION AND DIMENSIONS:**

Housing:

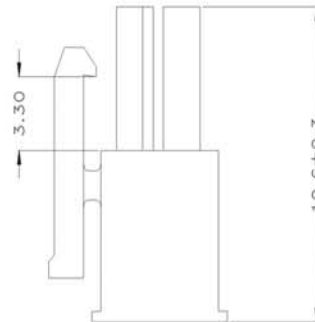
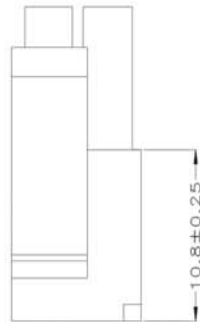
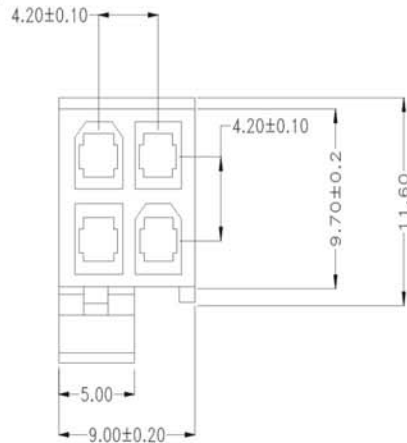

Mating with T6656 Series ,4200P Series Terminal.

Material Nylon 66

Housing Part Number:

H6657-\*04M3N(Natural)

H6657-\*04MB3N(Black)

Mate Housing

H6657-\*04M4N(Natural)

H6657-\*04MB4N(Black)





## 4.20mm Pitch Wire to board Connector

### 6657 Series

#### ORDERING INFORMATION AND DIMENSIONS:

#### Housing:

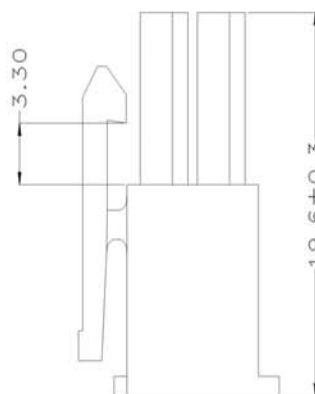
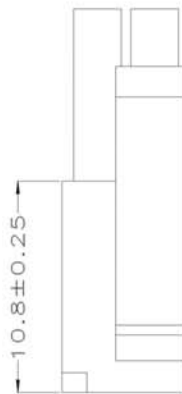
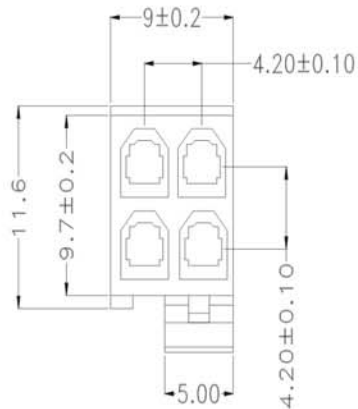

**Mating with T6656 Series ,4200P Series Terminal.**

**Material Nylon 66**

**Housing Part Number:**

H6657-\*04M4N(Natural)

H6657-\*04MB4N(Black)

**Mate Housing**

H6657-\*04M3N(Natural)

H6657-\*04MB3N(Black)